

- Key:**
- Red Line Boundary
 - Extents of Earthworks (cut)
 - Extents of Earthworks (fill)
 - Existing Ground Profile
 - Proposed Profile
 - Existing Watercourse

- Notes:**
1. Do not scale from this drawing.
 2. All dimensions are in metres unless otherwise stated.
 3. All spot elevations and contour levels indicated are in metres above Ordnance Datum (mAOD) unless otherwise indicated.
 4. This drawing is to be read with all other relevant drawings and reports.
 5. All works to be in accordance with the Specification for Highway Works.
 6. Please refer to 3.03.00 Environmental Statement Chapter 3: Description of Scheme for the Rochdale Envelope flexibility included within the design for the purposes of Environmental Impact Assessment.
 7. This drawing is for planning application purposes only, it is not a construction issue drawing.

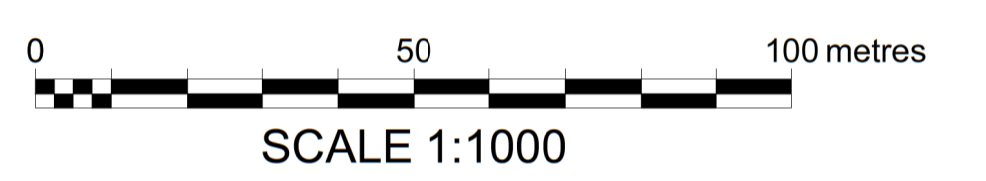

M-NWL-MAINLINE - LONGSECTION
SCALE: H 1:1000, V 1:200.
DATUM: 44.000

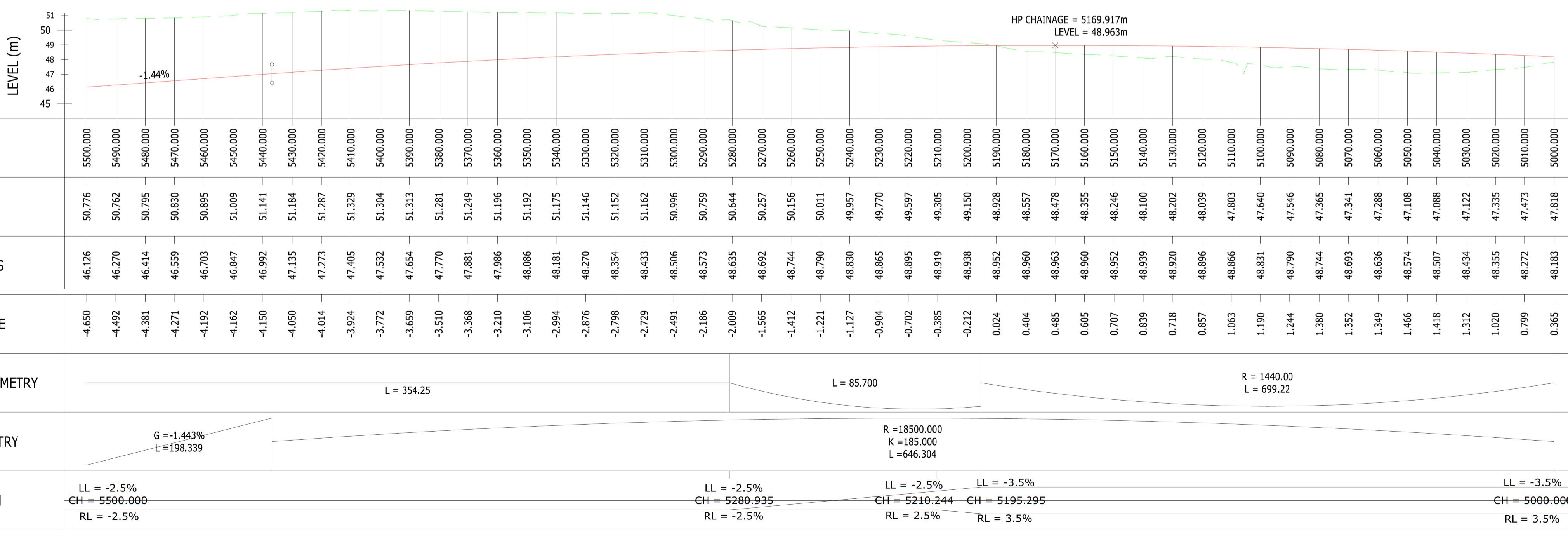

Mapping reproduced by permission of Ordnance Survey on behalf of HMSO.
© Crown copyright and database rights 2024 Ordnance Survey 100019340.

A1 - Authorised for Planning				
C01	KAK	SA	SS	08/02/24
REVISION	DRAWN	CHECKED	APPROVED	DATE

CLIENT
Norfolk County Council
 Grahame Bygrave
 Interim Executive Director of
 Community and Environmental services
 Norfolk County Council
 County Hall, Martineau Lane
 Norwich NR1 2SG

PROJECT

DRAWING TITLE
 NORWICH WESTERN LINK
 LONG SECTION
 SHEET 15 OF 16

DRAWING STATUS
 A1 - AUTHORISED FOR PLANNING

DRAWN	CHECKED	APPROVED	AUTHORISED
KAK	SA	SS	FQC
SCALE @ A1 SIZE	DATE	REVISION	
1:1000	08/02/24	C01	

DRAWING NUMBER
 PK1002-RAM-HGN-MLE-DR-CH-2616